

The background of the entire image is a close-up, high-contrast photograph of industrial machinery. It features several large, metallic gears or sprockets with sharp teeth, and several long, polished metal shafts or pins that are slightly out of focus, creating a sense of depth and industrial precision. The lighting is dramatic, with strong highlights and deep shadows.

 **GREMAKO®**

DOWEL  
&  
TAPER PINS

made by  
GREMAKO.



**Andreas Vollmert**  
CEO

**Sonja Vollmert**  
CEO

» We create lasting connections of the highest quality.  
Made by GREMAKO - 100% made in Germany «

We've specialized in the manufacture of dowel and taper pins for over 50 years. Our products are manufactured exclusively in Germany by skilled workers with many years of experience. We place quality above quantity and customer benefit above price.

Our skilled specialists strive each day to create connections that stand the test of time.

Community is our foundation, which is why we and our 80-strong team embody a strong brand.

© is for GREMAKO.

Our customers include machine engineering firms and tool makers, the fasteners trade and the automotive industry.

600 customers around the world place their trust in us and our products - and for good reason.

THERE'S RUN OF THE MILL  
AND THEN THERE'S US.



QUALITY  
MADE IN GERMANY





GREMAKO PRODUCTS IN USE

# KEEPING THINGS RUNNING SMOOTHLY

Every day, we use objects that rely on parts we can't see but which give them the stability and mobility we expect of the item as a whole. Many shelves are held together by small metal pins made by GREMAKO, our pins ensure that door locks turn smoothly every time and our products enable adjustable lighting to be reliably set to the desired position and stay there.



## APPLICATIONS



From the DIY hand drill to industrial machinery, from the washing machine to the construction crane, from the ski binding to the car gear stick-GREMAKO pins keep things together.



## WE CONNECT ADVANCED TECHNOLOGY AND PEOPLE

GREMAKO stands for robust and reliable connections that extend well beyond the products themselves: Our dowel and taper pins are essential for creating a precisely functioning finished product from numerous individual parts. The way we think and act brings together the people responsible for the success of the company: Our employees, customers and business partners.

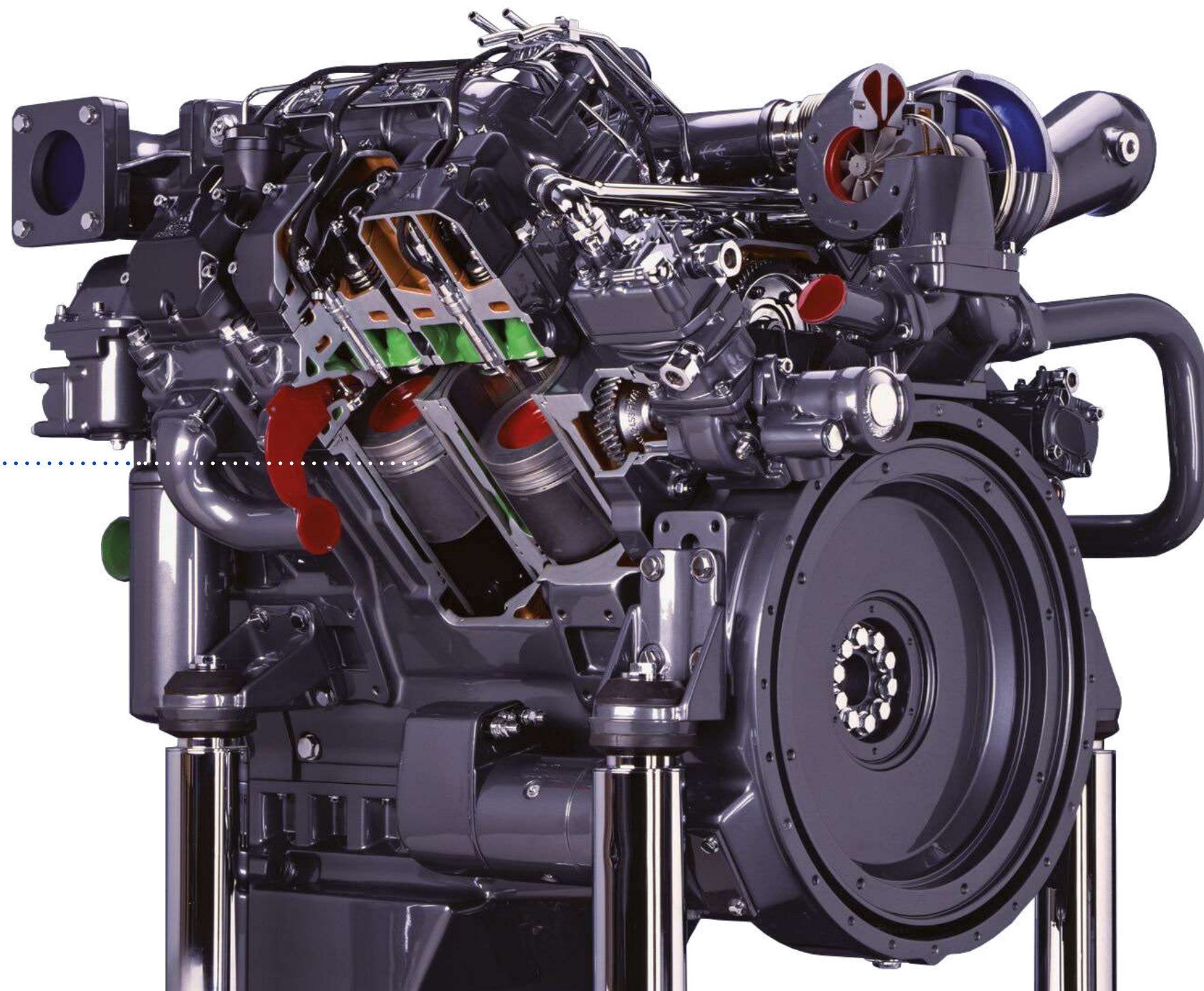





FOR PRODUCTS OF THE HIGHEST PRECISION

# CONCENTRATION DOWN TO THE SMALLEST OF DETAILS

Our dowel and taper pins are available in diameters of between one and thirty millimetres. They perform their magic in secret: They connect, hold and support. Our products are precision manufactured with close attention to detail and meticulous accuracy in Lennestadt, Germany.

GREMAKO's high quality standards and continual optimization of our manufacturing processes mean you can rely on the functionality, longevity and precision of all our dowel pins, taper pins and special parts.

Our focus is on extensive in-house production, uncompromising quality throughout the entire product range and excellent all-round service. Our proven track record in meeting customer's high expectations, of both us and our products, sets new standards in the global marketplace.

It's not without reason that many of our customers and business partners have been working with us for four generations already.

Utmost  
**precision**  
down to the smallest  
of details.







HIGH STANDARDS OF QUALITY  
IN PRODUCTION AND SERVICE

# FLEXIBILITY INCLUDED

Reacting rapidly to customer requests is an important pillar of our success. Besides the outstanding quality of service and products we offer, the range and quantity of products we keep in stock ensures our customers enjoy the highest level of product availability - our customers in Germany, Europe and overseas appreciate the flexibility and service GREMAKO offers in this respect too.

Around 35% of our production volume is dedicated to special parts - something that involves fulfilling special orders quickly and accurately. The majority of our production volume is taken up by the manufacture of standardized dowel and taper pins, however, which enables us to offer our customers a comprehensive range of products at all times.

GREMAKO GmbH & Co. KG is certified according to IATF 16949 and DIN EN ISO 9001. Successfully carrying out all the usual testing procedures is both a matter of course for us and a clear statement of our commitment to sustainable quality standards in both production and service.

65%  
dowel and  
taper pins





## PARTNERSHIP &amp; RESPONSIBILITY

# CREATING BONDS BETWEEN PEOPLE

While Germany is still our main market, we also supply our products to companies throughout Europe and the United States as well as Canada, South America and Asia, where we've been successful in developing new markets. And building exciting, sustainable relationships between people - across national borders and continents.

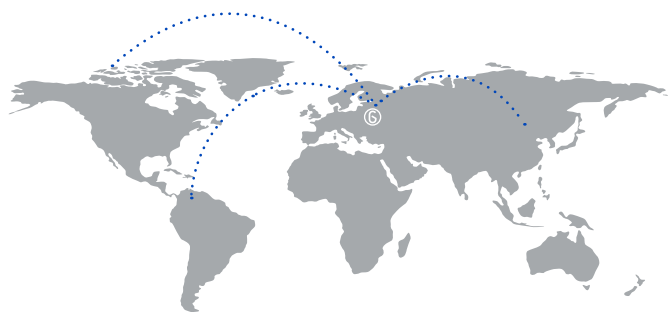

Successful partnerships are founded on trust. Trust in the performance and quality of the product, and of course, in the people that run the business. This means we have a duty to continually invest in the education and training of our employees.

The result is that our partners can be sure of the technical expertise, motivation and performance of the people at Gremako in the long term. This is something else that sets us apart from the competition and reinforces the trust placed in us each and every day.

Trust,  
**openness,**  
honesty and loyalty.







DOWEL/TAPER PINS ACCORDING TO STANDARD &amp; DRAFT

# PRODUCT PORTFOLIO

**Our „lorry pin“.**

This pin is built into the compressed air pistons found in lorries and makes it possible for the driver's cab to be swung open.

**Our „torque wrench pin“.**

This pin is built into torque wrenches and ensures that the torque wrench functions flawlessly.

**Our „little one“.**

This pin is just the size of an ant. 1 mm in diameter and 3 mm in length. It helps measuring devices to measure accurately.

**Our „signaller“.**

This pin is used in motors to pass on signals.

**Our „conveyor chain pin“.**

This pin is used in conveyor chains and helps the conveyor chain to transport everything perfectly.



DOWEL PIN

# PORTFOLIO

Dowel pins with internal thread in lengths from 8-150 mm

Standard	Form	Tol.	Material	Ø (mm)
DIN 7979	D	m6	Hardened steel	3-30
DIN 7979	D	h6	Hardened steel	3-30
DIN 7979	D	m5	Hardened steel	3-30

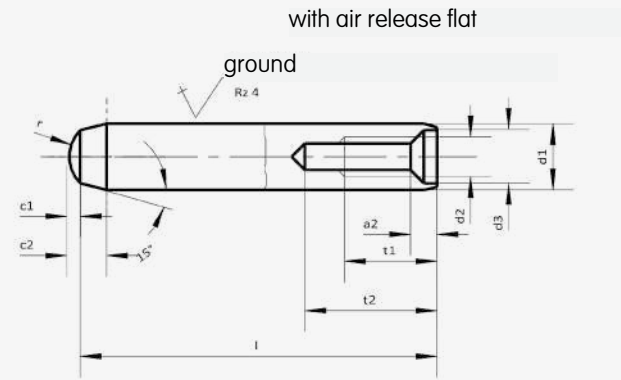

Standard	Form	Tol.	Material	Ø (mm)
DIN 7979	C	m6	Machining steel	4-30
DIN 7979	C	m6	1.4305	4-30

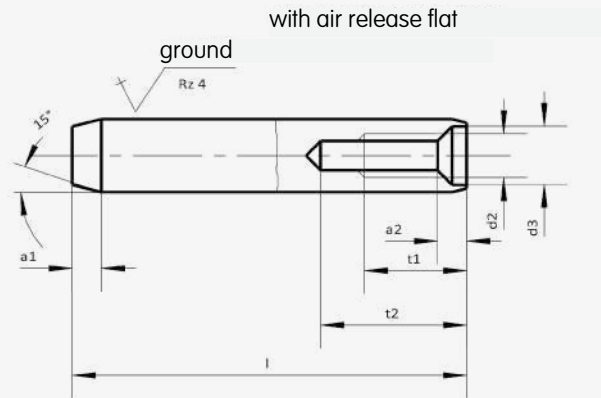

Dowel pins without thread in lengths from 3-150 mm

Standard	Form	Tol.	Material	Ø (mm)
DIN 7		m6	Machining steel	1-30
DIN 7		m6	1.4305	1-30
DIN 7		m6	1.4401	1-30
DIN 7		h6	1.4305	1-30

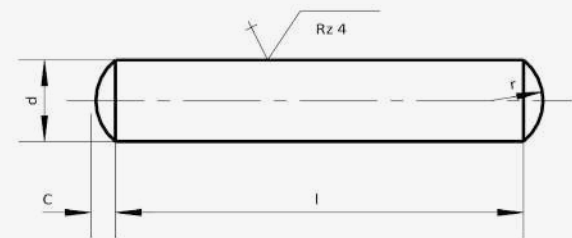

Standard	Form	Tol.	Material	Ø (mm)
DIN 7		h8	Machining steel	1-30
DIN 7		h8	1.4305	1-30

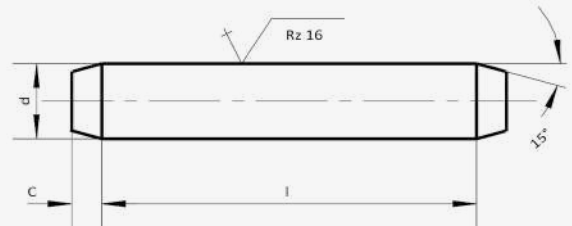

Dowel pins without thread in lengths from 3-150 mm

Standard	Form	Tol.	Material	Ø (mm)
DIN 6325		m6	Hardened steel	1-30
DIN 6325		h6	Hardened steel	1-30
DIN 6325		m5	Hardened steel	1-30

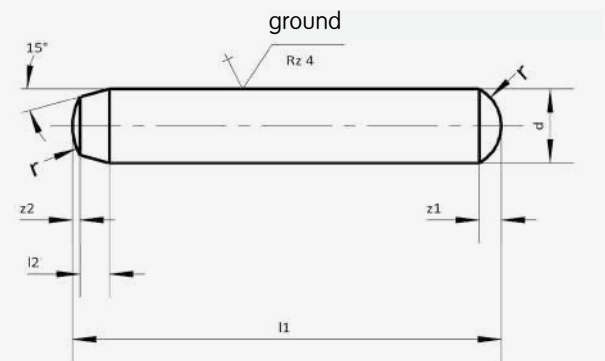

Standard	Form	Tol.	Material	Ø (mm)
ISO 8734A		m6	Hardened steel	1-30
ISO 8734A		h6	Hardened steel	1-30
ISO 8734A		m5	Hardened steel	1-30
ISO 8734		m6	1.4034, Hardened 550-650 HV30	1-30

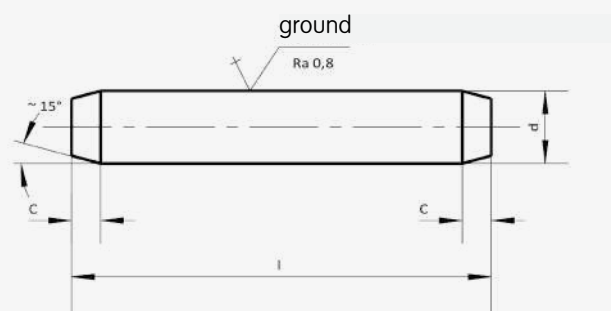

Dowel pins without thread in lengths from 3-150 mm

Standard	Form	Tol.	Material	Ø (mm)
ISO 2338		m6	Machining steel	1-30
ISO 2338		m6	1.4305	1-30
ISO 2338		m6	1.4401	1-30
ISO 2338		h8	Machining steel	1-30
ISO 2338		h8	1.4305	1-30

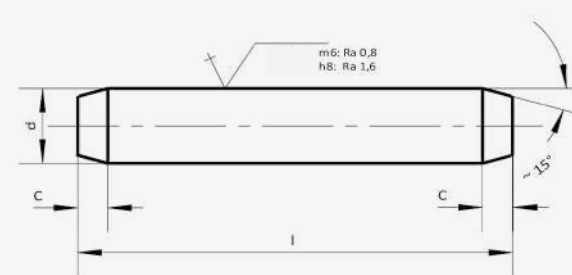





## TAPER PIN

## PORTFOLIO

## Taper pins without thread in lengths from 6-120 mm

Standard	Form	Material	Ø (mm)
DIN 1	A	Machining steel	3-25
DIN 1	B	Machining steel	2-25
DIN 1	B	1.4305	2-25

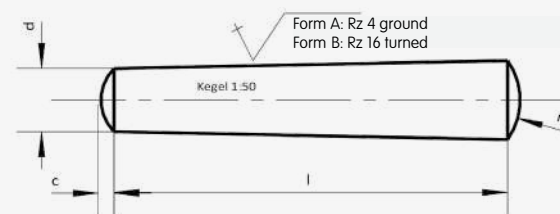

## Taper pins with threaded end and constant taper length

Standard	Form	Material	Ø (mm)
DIN 258		Machining steel	5-25

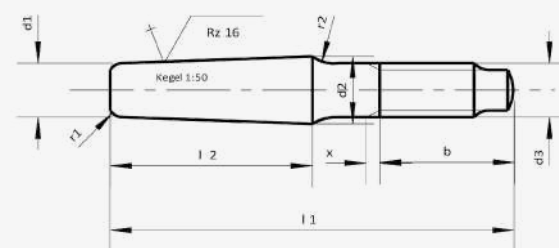

## Taper pins with internal thread in lengths from 16-120 mm

Standard	Form	Material	Ø (mm)
DIN 7978 (ISO 8736A)	A	Machining steel	5-25
DIN 7978 (ISO 8736A)	A	Hardened steel	5-25

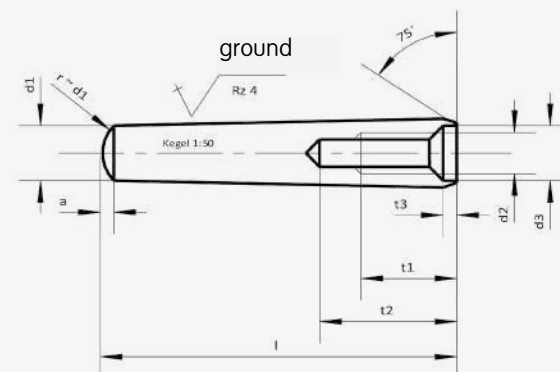

## Taper pins with constant-length threaded ends

Standard	Form	Material	Ø (mm)
DIN 7977 (ISO 8737)		Machining steel	5-25

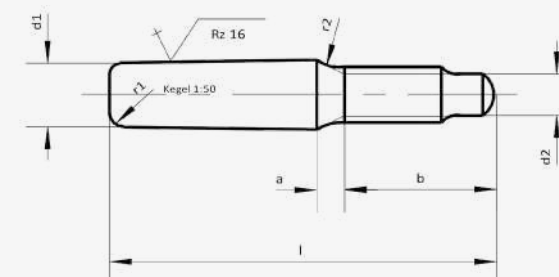

THERE'S RUN OF THE MILL  
AND THEN THERE'S US.

QUALITY  
MADE IN GERMANY



WE HAVE THE LARGEST STORE OF  
DOWEL AND TAPER PINS IN THE WORLD

Our intelligent warehouse management system means we offer the highest level of product availability there is.

## MANUFACTURING CAPABILITIES FOR SPECIAL PARTS

### Turning

- Diameter: 1-30 mm
- Length: 3-150 mm

### Grinding

- Centreless grinding
- Surface grinding
- Slide grinding

### Tolerances

- Diameter: starting from 0,005 mm
- Length: starting from 0,1 mm
- Surface quality grinding: Rz < 2

### Materials

- Heat treatable steel
- Case hardened steel
- Machining steel
- Stainless steel

### Precision/Fine cleaning

- Precision/Fine cleaning according to VDA volume 19, ISO 16232 and customer specifications

### Heat treatments

- Hardening
- Tempering
- Case-hardening
- Induction-hardening
- Bath-nitriding adapted from Tenifer
- Gas-nitriding

### Surface treatments

- Burnishing
- Phosphating
- Galvanizing
- Nickel plating
- Zinc-Nickeling
- Zinc-Iron
- Hard chromium plating
- chemical nickel plating, Delta Seal, Delta Tone, etc.

### Testing

- hardness-testing adapted from HRC and HB, HV starting with 1, case-hardening-testing
- roughness and crack testing
- 100% length- and diameter-testing
- initial sampling adapted from VDA and PPAP



IMPRESSED?  
PLEASE DON'T HESITATE TO  
CONTACT US.



PHONE  
+49 (0) 2721 / 132-0

E-MAIL  
[sales@gremako.de](mailto:sales@gremako.de)

 **REMAKO®**

[www.gremako.de](http://www.gremako.de)